

Refuse Strategy:

- Core F1
52 units
11no. 1100l General waste bins
7no. 240l Dry recycling bins
- Core F2
61 units
12no. 1100l General waste bins
8no. 240l Dry recycling bins
- Core F3
56 units
11no. 1100l General waste bins
7no. 240l Dry recycling bins

*calculation based on Barnet Council "Provision of Household recycling and refuse waste collection services" 2014

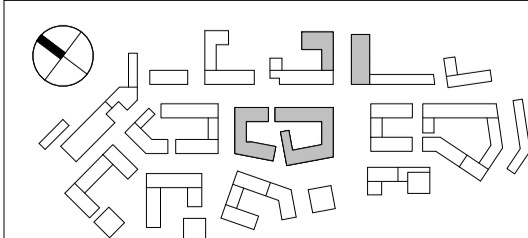

Do not scale from this drawing. Use figured dimensions only. Figured dimensions are in millimetres. All dimensions shall be verified on site before proceeding with works. All levels are nominal: detailed site survey to be carried out to verify positions and level relationships with site features and ordnance survey. All levels are in metres. This drawing is for design intent only. This drawing is to be read in conjunction with other documentation from the architect, design team, main contractor and employer's agent. The architect must be notified of any discrepancies.

REV	DATE	DESCRIPTION	CD
P1	05.12.2014	PLANNING APPLICATION	MD

*Indicative Landscaping - Refer to Landscape Architects Drawings

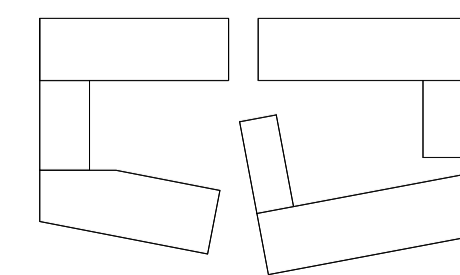

Allies and Morrison
Architects
85 Southwark Street
London SE1 0HX
Telephone 020 7921 0100
Facsimile 020 7921 0101
Email info@alliesandmorrison.co.uk

West Hendon : Block F
Lower Ground Floor Plan Refuse Strategy

765_05_07_120

A&M JOB NO: 765_05

SCALE 1 : 200 @ A1