

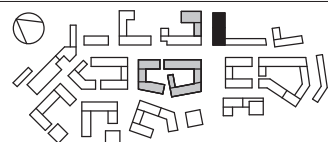

North-West Elevation bat box location

8 no. bat boxes integrated into brick panels



Bat brick type:
 Finish to match proposed facade brick type.
<http://www.nhbs.com/title/184752/bat-brick>

| DATE | REV | DESCRIPTION | CHK |
|----------|-----|----------------------------|-----|
| 20.11.14 | P1 | Sign-Off Drawing Issue | JR |
| 25.11.14 | P2 | Planning Application Issue | JR |
| | | | |
| | | | |
| | | | |